



## Brookland Close, Hastings TN34 2DF

Offers in excess of £290,000



Stunning three bedroom DETACHED HOUSE with off road parking. Tucked away in a quiet CUL DE SAC this beautiful home is presented to an exceptional standard throughout, the CONTEMPORARY KITCHEN flows into the open plan dining area with BI-FOLDING DOORS opening on to a private and SUNNY REAR GARDEN. The generous living room is the perfect FAMILY SPACE with sliding doors into the CONSERVATORY. There is a handy DOWNSTAIRS SHOWER ROOM and a central staircase leading up to the first floor where there are THREE DOUBLE BEDROOMS, two with built in wardrobes, the family bathroom can also be found on this level. Found in a favoured BLACKLANDS LOCATION, close to local Schools, Alexandra Park and a short stroll from Hastings Town centre this fab home is not one to be missed.

GROUND FLOOR  
789 sq. ft. (73.3 sq. m.) approx.

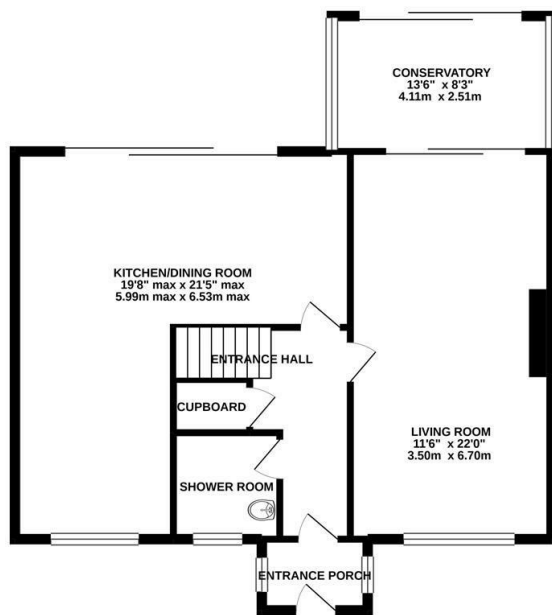

1ST FLOOR  
473 sq. ft. (44.0 sq. m.) approx.

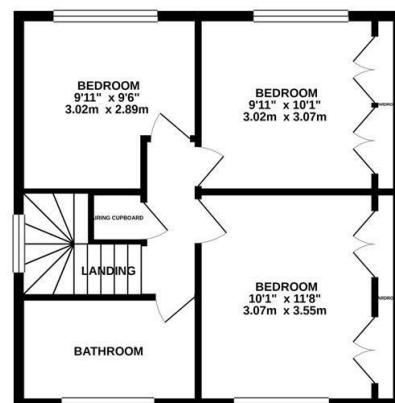

TOTAL FLOOR AREA: 1262 sq. ft. (117.3 sq. m.) approx.

Whilst every attempt has been made to ensure the accuracy of the floorplan contained here, measurements of doors, windows, rooms and any other items are approximate and no responsibility is taken for any error, omission or mis-statement. This plan is for illustrative purposes only and should be used as such by any prospective purchaser. The services, systems and appliances shown have not been tested and no guarantee as to their operability or efficiency can be given.

Made with Metropix ©2020

